

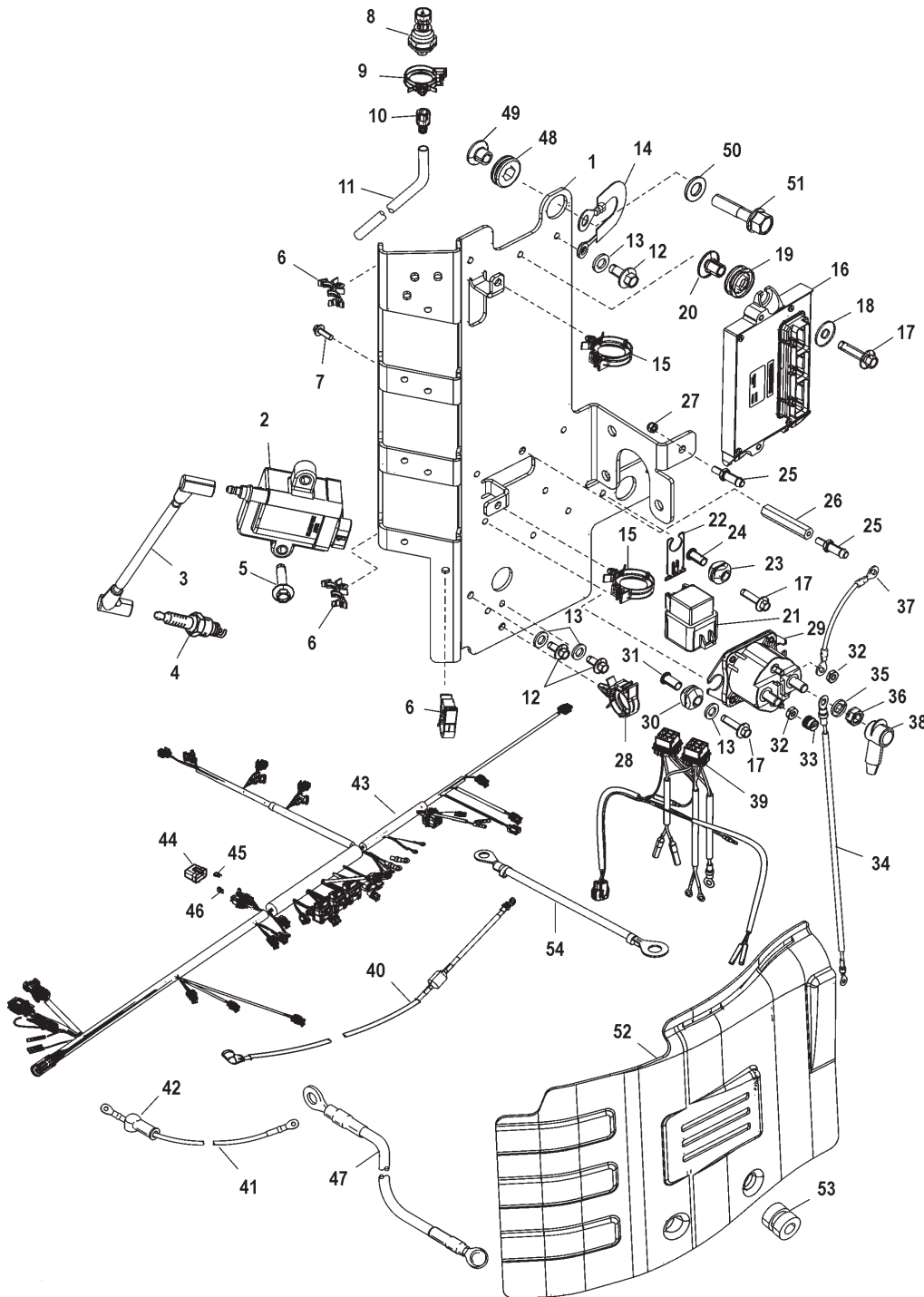

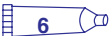

Electrical Components



1691

Tube Ref. No.	Description	Mercury Part Number	Quicksilver Part Number
 6	Dielectric Grease	92-823506-1	92-823506-1
 25	Liquid Neoprene	92-25711-3	92-25711-3

NOTE: Coat all eyelet wiring terminals with Liquid Neoprene.

NOTE: Coat all multi-pin electrical connections (except power trim relay connections) with Dielectric Grease.